

Snap Ring, Internal, Inch

Designed for needle bearings, once installed in the groove of a housing/bore, the portion of the ring protruding from the groove holds an assembly in place.

HN Constant Section Rings

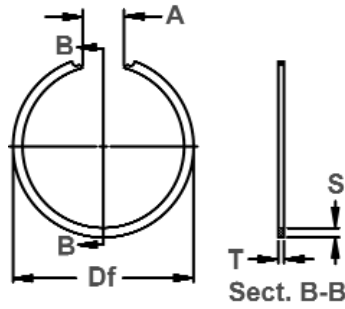

Free Diameter & Ring Measurement with Section B-B

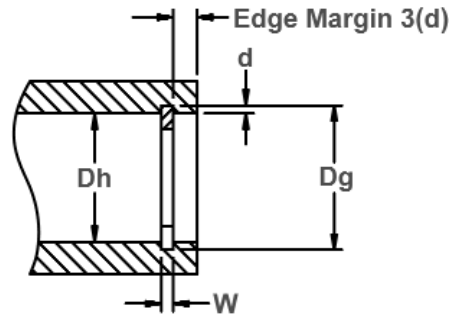

Housing Diameter & Groove Dimensions

Material SAE 1060-1075

RING SIZE	HOUSING DIAMETER			GROOVE SIZE			RING DIMENSIONS					ALLOWABLE STATIC THRUST LOAD (Lbs.)			
				DIAMETER		WIDTH	DEPTH	FREE DIAMETER		THICKNESS	SECTION			FREE GAP	
	Dh DEC	Dh FRACT.	Dh mm	Dg	TOL.	W	d	Df	TOL.	T ±.002	S			TOL.	A Min
HN-112	1.125	1-1/8	28.58	1.181	± .005	.046	.028	1.196	+.031	.042	.093	± .003	.375	.562	1100
HN-125	1.250	1-1/4	31.75	1.310			.030	1.330		.042	.093		.375	.562	1360
HN-137	1.375	1-3/8	34.93	1.435			.030	1.460		.042	.093		.375	.562	1600
HN-150	1.500	1-1/2	38.10	1.580			.040	1.600		.042	.125		.375	.562	1900
HN-162	1.625	1-5/8	41.28	1.705			.040	1.725		.042	.125		.437	.750	1930
HN-175	1.750	1-3/4	44.45	1.830			.040	1.855		.042	.125		.437	.750	1960
HN-187	1.875	1-7/8	47.63	1.965			.045	1.990		.042	.156		.437	.750	2090
HN-200	2.000	2	50.80	2.090			.045	2.115		.042	.156		.437	.750	2200
HN-206	2.062	2-1/16	52.37	2.152			.045	2.177		.042	.156		.437	.750	2340
HN-218	2.187	2-3/16	55.55	2.277			.045	2.302		.042	.156		.437	.750	2700
HN-231	2.312	2-5/16	58.72	2.402	.045	2.432	.042	.156	.437	.750	2900				
HN-243	2.437	2-7/16	61.90	2.527	.045	2.557	.042	.156	.437	.750	3000				
HN-256	2.562	2-9/16	65.07	2.652	.045	2.682	.042	.156	.437	.750	3200				
HN-300	3.000	3	76.20	3.124	± .006	.068	.062	3.154	+.078	.062	.187	± .005	.562	.938	6250
HN-325	3.250	3-1/4	82.55	3.374			.062	3.404		.062	.187		.562	.938	6500
HN-350	3.500	3-1/2	88.90	3.624			.062	3.654		.062	.187		.562	.938	6700
HN-375	3.750	3-3/4	95.25	3.874			.062	3.904		.062	.187		.562	.938	6100
HN-400	4.000	4	101.60	4.125			.062	4.155		.062	.187		.562	.938	7000
HN-425	4.250	4-1/4	107.95	4.394			.072	4.429		.078	.218		.625	1.062	9100
HN-450	4.500	4-1/2	114.30	4.644			.072	4.679		.078	.218		.625	1.062	9400
HN-475	4.750	4-3/4	120.65	4.894			.072	4.929		.078	.218		.625	1.062	9200
HN-500	5.000	5	127.00	5.144			.072	5.184		.078	.218		.625	1.062	9000
HN-525	5.250	5-1/4	133.35	5.394			.072	5.434		.078	.218		.625	1.062	8800
HN-575	5.750	5-3/4	146.05	5.894	.072	5.934	.078	.218	.625	1.062	8950				
HN-600	6.000	6	152.40	6.160	± .007	.103	.080	6.220	+.125	.093	.250	± .005	.875	1.437	9000
HN-650	6.500	6-1/2	165.10	6.660			.080	6.730		.093	.250		.875	1.437	7500
HN-700	7.000	7	177.80	7.160			.080	7.240		.093	.250		.875	1.437	6200
HN-725	7.250	7-1/4	184.15	7.410			.080	7.500		.093	.250		1.000	1.750	6100
HN-750	7.500	7-1/2	190.50	7.660			.080	7.760		.093	.250		1.000	1.750	6000
HN-800	8.000	8	203.20	8.160			.080	8.285		.093	.250		1.000	1.750	5700

Hardness: All Ring Sizes-HRC 42-52