

# MCM Spiral Shaft Rings

## External, Medium Duty, Metric

These rings offer the greatest economy in price and size.

They are able to handle approximately twice the thrust capacity of the MCL series.

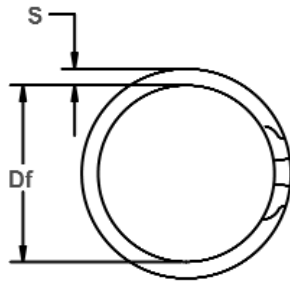

Free Diameter & Ring Measurements

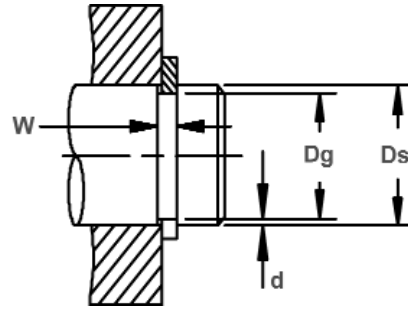
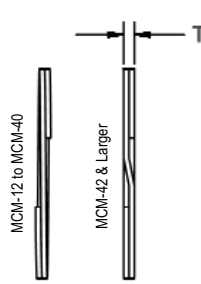

Shaft Diameter & Groove Dimensions

RING NO.	SHAFT DIAMETER	GROOVE SIZE				RING SIZE					
		DIAMETER		WIDTH		FREE DIAMETER		THICKNESS		SECTION	
		(mm)	Dg	Tol.	W	Tol.	Df	Tol.	T	Tol.	S
MCM-12	12	11.34	+ 0.10 -0.00	0.75	+ 0.08 -0.00	11.21	± 0.33	0.64	+0.05 -0.05	1.14	+0.08 -0.13
MCM-13	13	12.28		0.75		12.15		0.64		1.14	
MCM-14	14	13.28		0.75		13.15		0.64		1.14	
MCM-15	15	14.28		0.75		14.15		0.64		1.14	
MCM-16	16	15.14		0.75		14.98		0.64		1.40	
MCM-17	17	16.14		0.75		15.98		0.64		1.40	
MCM-18	18	17.14		0.75		16.98		0.64		1.40	
MCM-19	19	18.14		0.91		17.98		0.80		1.65	
MCM-20	20	19.14		0.91		18.98		0.80		1.65	
MCM-21	21	20.14		0.91		19.98		0.80		1.65	
MCM-22	22	21.00	0.91	20.82	0.80	1.65					
MCM-23	23	22.00	0.91	21.82	0.80	1.65					
MCM-24	24	23.00	0.91	22.80	0.80	1.65					
MCM-25	25	23.84	+0.13 -0.00	1.07	23.64	0.94	1.90				
MCM-26	26	24.84		1.07	24.61	0.94	1.90				
MCM-27	27	25.84		1.07	25.61	0.94	1.90				
MCM-28	28	26.84		1.07	26.61	0.94	1.90				
MCM-29	29	27.84	+0.20 -0.00	1.07	27.61	0.94	1.90				
MCM-30	30	28.68		1.22	28.45	1.10	2.16				
MCM-32	32	30.68		1.22	30.43	1.10	2.16				
MCM-33	33	31.68		1.22	31.42	1.10	2.40				
MCM-34	34	32.68		1.22	32.43	1.10	2.40				
MCM-35	35	33.60		1.22	33.32	1.10	2.40				
MCM-36	36	34.60		1.22	34.32	1.10	2.40				
MCM-37	37	35.66		1.22	35.36	1.10	2.40				
MCM-38	38	36.60		1.22	36.32	1.10	2.40				
MCM-39	39	37.48		+0.25 -0.00	1.42	37.25	1.25	2.75			
MCM-40	40	38.48	1.42		38.18	1.25	2.75				
MCM-42	42	40.40	1.42		40.10	1.25	2.75				
MCM-43	43	41.38	1.42		41.04	1.25	3.00				
MCM-44	44	42.38	1.42		42.06	1.25	3.00				
MCM-45	45	43.28	1.42		42.95	1.25	3.00				
MCM-47	47	45.22	1.42		44.85	1.25	3.25				
MCM-48	48	46.20	1.42		45.85	1.25	3.25				
MCM-50	50	48.20	1.42		47.82	1.25	3.25				
MCM-52	52	50.00	1.42		49.62	1.25	3.25				
MCM-53	53	51.00	+0.30 -0.00	1.42	50.62	1.25	3.25				
MCM-54	54	52.00		1.42	51.62	1.25	3.25				
MCM-55	55	53.00		1.42	52.62	1.25	3.50				
MCM-56	56	54.00		1.42	53.62	1.25	3.50				
MCM-58	58	55.86		1.42	55.43	1.25	3.50				
MCM-59	59	56.86		1.42	56.43	1.25	3.50				
MCM-60	60	57.86		1.42	57.43	1.25	3.50				
MCM-61	61	58.76		1.42	58.36	1.25	3.50				
MCM-62	62	59.76		1.42	59.30	1.25	3.76				

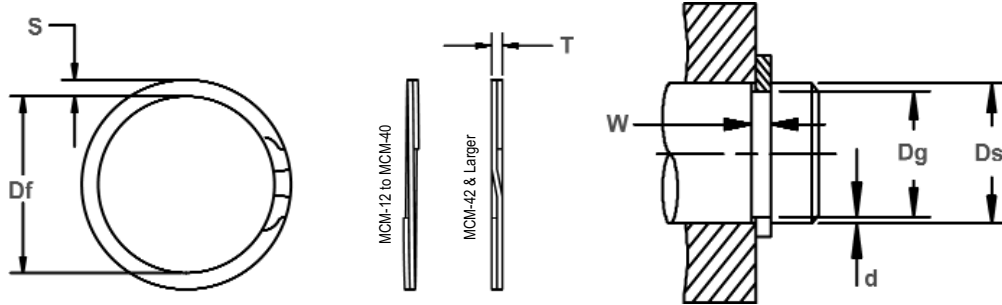

Free Diameter & Ring Measurements

Shaft Diameter & Groove Dimensions

RING NO.	SHAFT DIAMETER	GROOVE SIZE				RING SIZE					
		DIAMETER		WIDTH		FREE DIAMETER		THICKNESS		SECTION	
		(mm)	Dg	Tol.	W	Tol.	Df	Tol.	T	Tol.	S
MCM-63	63	60.76		1.42		60.30		1.25		3.76	
MCM-64	64	61.76		1.42		61.25		1.25		3.76	
MCM-65	65	62.66		1.42		62.20	± 0.63	1.25		3.76	
MCM-66	66	63.64		1.42		63.16		1.25		3.76	
MCM-67	67	64.56		1.42	+0.10	64.16		1.25		3.76	
MCM-68	68	65.56		1.42	-0.00	65.08		1.25		4.00	
MCM-69	69	66.56		1.42		66.06		1.25		4.00	
MCM-70	70	67.56		1.42		67.08		1.25		4.00	
MCM-71	71	68.56		1.42		68.04		1.25	+0.08	4.00	
MCM-72	72	69.50		1.42		69.00		1.25	-0.08	4.27	
MCM-75	75	72.46	+0.30	1.42		71.93	± 0.76	1.25		4.27	
MCM-78	78	75.40	-0.00	1.73		74.84		1.55		4.27	
MCM-80	80	77.36		1.73		76.80		1.55		4.52	
MCM-82	82	79.30		1.73		78.72		1.55		4.52	
MCM-85	85	82.20		1.73		81.62		1.55		4.77	
MCM-88	88	85.16		1.73		84.53		1.55		4.77	
MCM-90	90	87.06		1.73		86.43		1.55		5.03	
MCM-95	95	92.00		1.73		91.37		1.55		5.03	
MCM-100	100	96.86		1.73		96.10		1.55		5.28	
MCM-105	105	101.70		1.73	+0.13	100.94	± 0.99	1.55		5.53	+0.10
MCM-110	110	106.54	-0.00	1.73		105.75		1.55		5.80	-0.15
MCM-115	115	111.40		1.73		110.59		1.55		6.05	
MCM-120	120	116.30		2.00		115.49		1.83		6.35	
MCM-125	125	121.30		2.00		120.44		1.83		6.35	
MCM-130	130	126.20		2.00		125.34		1.83		6.35	
MCM-135	135	131.10		2.00		130.20		1.83		6.35	
MCM-140	140	136.08	+0.35	2.00		135.14	± 1.30	1.83		6.35	
MCM-145	145	141.00	-0.00	2.00		140.00		1.83		6.35	
MCM-150	150	146.00		2.00		145.00		1.83		6.35	
MCM-155	155	150.40		2.40		149.33		2.18		7.92	
MCM-160	160	155.40		2.40		154.31		2.18		7.92	
MCM-165	165	160.40		2.40		159.23		2.18		7.92	
MCM-170	170	165.20		2.40		164.00	± 1.52	2.18	+0.10	7.92	
MCM-175	175	170.20		2.40		169.00		2.18	-0.10	7.92	
MCM-180	180	175.00		2.40		173.78		2.18		7.92	
MCM-185	185	180.00		2.40	+0.15	178.70		2.18		7.92	
MCM-190	190	185.00		2.40	-0.00	183.70		2.18		7.92	
MCM-195	195	189.80	+0.40	2.40		188.43		2.18		7.92	+0.10
MCM-200	200	194.80	-0.00	2.40		193.43		2.18		7.92	-0.20
MCM-210	210	204.40		2.40		202.93		2.18		9.52	
MCM-220	220	214.20		2.40		212.65	± 1.78	2.18		9.52	
MCM-230	230	224.20		2.40		222.60		2.18		9.52	
MCM-240	240	234.00		2.40		232.32		2.18		9.52	
MCM-250	250	243.60		2.40		241.83		2.18		9.52	
MCM-260	260	253.40		2.40		251.57		2.18		9.52	