

# CM Spiral Shaft Rings

## External, Medium Duty

These rings offer the greatest economy in price and size. They are able to handle approximately twice the thrust capacity of the CL series, and to be produced to military specifications if needed.

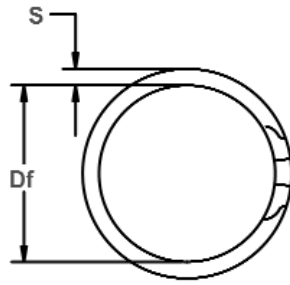

Free Diameter & Ring Measurements

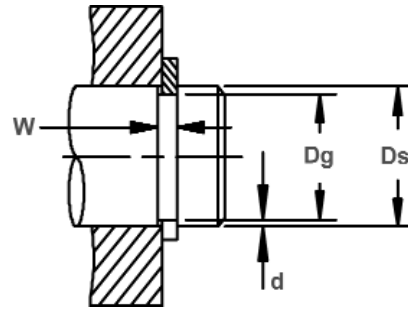
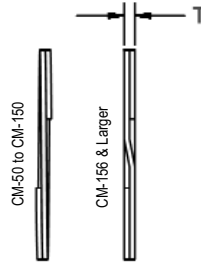

Shaft Diameter & Groove Dimensions

| RING NO. | SHAFT DIAMETER | GROOVE SIZE |        |       |        |       | RING SIZE     |        |           |        | THRUST LOAD (lbs.) |        |                         |                           |
|----------|----------------|-------------|--------|-------|--------|-------|---------------|--------|-----------|--------|--------------------|--------|-------------------------|---------------------------|
|          |                | DIAMETER    |        | WIDTH |        | DEPTH | FREE DIAMETER |        | THICKNESS |        | SECTION            |        | RING Safety factor of 3 | GROOVE Safety factor of 2 |
|          |                | (In.)       | Dg     | Tol.  | W      | Tol.  | d             | Df     | Tol.      | T      | Tol.               | S      |                         |                           |
| CM-50    | .500           | .474        |        | .030  |        | .013  | .467          |        | .025      |        | .045               |        | 2000                    | 460                       |
| CM-53    | .531           | .505        | + .002 | .030  |        | .013  | .498          |        | .025      |        | .045               |        | 2130                    | 490                       |
| CM-55    | .551           | .525        | - .002 | .030  |        | .013  | .518          |        | .025      |        | .045               |        | 2210                    | 510                       |
| CM-56    | .562           | .536        |        | .030  |        | .013  | .529          |        | .025      |        | .045               |        | 2250                    | 520                       |
| CM-59    | .594           | .569        |        | .030  |        | .013  | .561          |        | .025      |        | .045               |        | 2380                    | 550                       |
| CM-62    | .625           | .594        |        | .030  |        | .016  | .585          |        | .025      |        | .055               |        | 2500                    | 710                       |
| CM-65    | .656           | .625        |        | .030  |        | .016  | .617          |        | .025      |        | .055               |        | 2630                    | 740                       |
| CM-66    | .669           | .638        |        | .030  |        | .016  | .629          |        | .025      |        | .055               |        | 2680                    | 760                       |
| CM-68    | .687           | .656        |        | .030  |        | .016  | .647          |        | .025      |        | .055               |        | 2750                    | 780                       |
| CM-71    | .718           | .687        |        | .030  |        | .016  | .679          |        | .025      |        | .055               |        | 2880                    | 810                       |
| CM-75    | .750           | .719        |        | .036  |        | .016  | .710          | + .000 | .031      |        | .065               |        | 3360                    | 850                       |
| CM-78    | .781           | .750        | + .003 | .036  | + .003 | .016  | .741          | - .013 | .031      |        | .065               |        | 3500                    | 880                       |
| CM-81    | .812           | .781        | - .003 | .036  | - .000 | .016  | .771          |        | .031      |        | .065               |        | 3640                    | 920                       |
| CM-84    | .843           | .812        |        | .036  |        | .016  | .803          |        | .031      |        | .065               |        | 3780                    | 950                       |
| CM-87    | .875           | .838        |        | .036  |        | .019  | .828          |        | .031      |        | .065               |        | 3920                    | 1180                      |
| CM-90    | .906           | .869        |        | .036  |        | .019  | .860          |        | .031      |        | .065               |        | 4060                    | 1220                      |
| CM-93    | .937           | .900        |        | .036  |        | .019  | .889          |        | .031      | + .002 | .065               | + .004 | 4200                    | 1260                      |
| CM-96    | .968           | .925        |        | .042  |        | .021  | .916          |        | .037      | - .002 | .075               | - .004 | 5180                    | 1440                      |
| CM-98    | .984           | .941        |        | .042  |        | .021  | .930          |        | .037      |        | .075               |        | 5260                    | 1460                      |
| CM-100   | 1.000          | .957        |        | .042  |        | .021  | .946          |        | .037      |        | .075               |        | 5350                    | 1480                      |
| CM-102   | 1.023          | .980        |        | .042  |        | .021  | .968          |        | .037      |        | .075               |        | 5470                    | 1520                      |
| CM-103   | 1.031          | .988        |        | .042  |        | .021  | .978          |        | .037      |        | .075               |        | 5510                    | 1530                      |
| CM-106   | 1.062          | 1.020       |        | .042  |        | .021  | 1.007         |        | .037      |        | .075               |        | 5680                    | 1580                      |
| CM-109   | 1.093          | 1.051       |        | .042  |        | .021  | 1.040         |        | .037      |        | .075               |        | 5840                    | 1620                      |
| CM-112   | 1.125          | 1.083       |        | .042  |        | .021  | 1.070         |        | .037      |        | .075               |        | 6020                    | 1670                      |
| CM-115   | 1.156          | 1.114       |        | .042  |        | .021  | 1.102         |        | .037      |        | .075               |        | 6180                    | 1720                      |
| CM-118   | 1.188          | 1.140       |        | .048  |        | .024  | 1.127         |        | .043      |        | .085               |        | 7380                    | 2020                      |
| CM-121   | 1.218          | 1.170       |        | .048  |        | .024  | 1.159         |        | .043      |        | .085               |        | 7570                    | 2070                      |
| CM-125   | 1.250          | 1.202       | + .004 | .048  |        | .024  | 1.188         | + .000 | .043      |        | .085               |        | 7770                    | 2120                      |
| CM-128   | 1.281          | 1.233       | - .004 | .048  |        | .024  | 1.221         | - .015 | .043      |        | .085               |        | 7960                    | 2170                      |
| CM-131   | 1.312          | 1.264       |        | .048  | + .004 | .024  | 1.251         |        | .043      |        | .095               |        | 8150                    | 2230                      |
| CM-134   | 1.343          | 1.295       |        | .048  | - .000 | .024  | 1.282         |        | .043      |        | .095               |        | 8350                    | 2280                      |
| CM-137   | 1.375          | 1.323       |        | .048  |        | .026  | 1.308         |        | .043      |        | .095               |        | 8540                    | 2530                      |
| CM-140   | 1.406          | 1.354       |        | .048  |        | .026  | 1.340         |        | .043      |        | .095               |        | 8740                    | 2580                      |
| CM-143   | 1.437          | 1.385       |        | .048  |        | .026  | 1.370         |        | .043      |        | .095               |        | 8930                    | 2640                      |
| CM-146   | 1.468          | 1.416       |        | .048  |        | .026  | 1.402         |        | .043      |        | .095               |        | 9120                    | 2700                      |
| CM-150   | 1.500          | 1.448       |        | .048  |        | .026  | 1.433         |        | .043      |        | .095               |        | 9320                    | 2760                      |

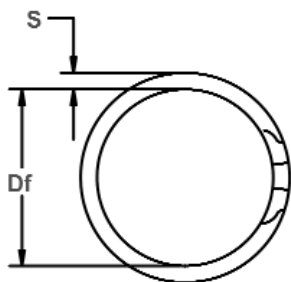

Free Diameter & Ring Measurements

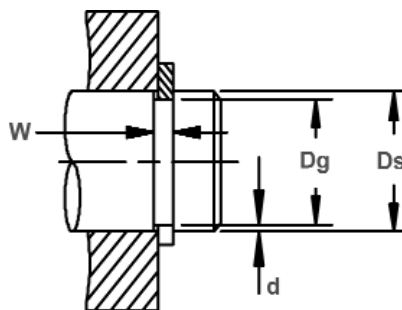
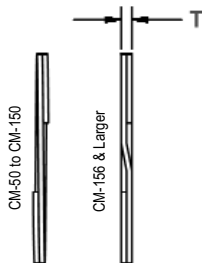

Shaft Diameter & Groove Dimensions

| RING NO. | SHAFT DIAMETER | GROOVE SIZE |                |       |                |       | RING SIZE     |                |           |                | THRUST LOAD (lbs.) |                |                         |                           |
|----------|----------------|-------------|----------------|-------|----------------|-------|---------------|----------------|-----------|----------------|--------------------|----------------|-------------------------|---------------------------|
|          |                | DIAMETER    |                | WIDTH |                | DEPTH | FREE DIAMETER |                | THICKNESS |                | SECTION            |                | RING Safety factor of 3 | GROOVE Safety factor of 2 |
|          |                | Dg          | Tol.           | W     | Tol.           | d     | Df            | Tol.           | T         | Tol.           | S                  | Tol.           |                         |                           |
| CM-156   | 1.562          | 1.507       | +.005<br>-.005 | .056  | +.004<br>-.000 | .028  | 1.490         | +.000<br>-.020 | .049      | +.003<br>-.003 | .108               | +.004<br>-.004 | 10100                   | 3090                      |
| CM-157   | 1.575          | 1.520       |                | .056  |                | .028  | 1.503         |                | .049      |                | .108               |                | 10190                   | 3120                      |
| CM-162   | 1.625          | 1.566       |                | .056  |                | .030  | 1.549         |                | .049      |                | .108               |                | 10510                   | 3450                      |
| CM-168   | 1.687          | 1.628       |                | .056  |                | .030  | 1.610         |                | .049      |                | .118               |                | 10910                   | 3580                      |
| CM-175   | 1.750          | 1.691       |                | .056  |                | .030  | 1.673         |                | .049      |                | .118               |                | 11310                   | 3710                      |
| CM-177   | 1.771          | 1.708       |                | .056  |                | .032  | 1.690         |                | .049      |                | .118               |                | 11450                   | 4010                      |
| CM-181   | 1.813          | 1.749       |                | .056  |                | .032  | 1.730         |                | .049      |                | .118               |                | 11720                   | 4100                      |
| CM-187   | 1.875          | 1.808       |                | .056  |                | .034  | 1.789         |                | .049      |                | .128               |                | 12120                   | 4510                      |
| CM-193   | 1.938          | 1.871       |                | .056  |                | .034  | 1.851         |                | .049      |                | .128               |                | 12530                   | 4660                      |
| CM-196   | 1.969          | 1.902       |                | .056  |                | .034  | 1.882         |                | .049      |                | .128               |                | 12730                   | 4730                      |
| CM-200   | 2.000          | 1.929       | .056           | .035  | 1.909          | .049  | .128          | 12930          | 4950      |                |                    |                |                         |                           |
| CM-206   | 2.062          | 1.992       | .056           | .035  | 1.971          | .049  | .128          | 13330          | 5100      |                |                    |                |                         |                           |
| CM-212   | 2.125          | 2.051       | .056           | .037  | 2.029          | .049  | .128          | 13740          | 5560      |                |                    |                |                         |                           |
| CM-215   | 2.156          | 2.082       | .056           | .037  | 2.060          | .049  | .138          | 13940          | 5640      |                |                    |                |                         |                           |
| CM-216   | 2.165          | 2.091       | .056           | .037  | 2.070          | .049  | .138          | 14000          | 5660      |                |                    |                |                         |                           |
| CM-218   | 2.188          | 2.113       | .056           | .037  | 2.092          | .049  | .138          | 14150          | 5720      |                |                    |                |                         |                           |
| CM-225   | 2.250          | 2.176       | .056           | .037  | 2.153          | .049  | .138          | 14550          | 5890      |                |                    |                |                         |                           |
| CM-231   | 2.312          | 2.234       | .056           | .039  | 2.211          | .049  | .138          | 14950          | 6370      |                |                    |                |                         |                           |
| CM-236   | 2.362          | 2.284       | .056           | .039  | 2.261          | .049  | .138          | 15270          | 6510      |                |                    |                |                         |                           |
| CM-237   | 2.375          | 2.297       | .056           | .039  | 2.273          | .049  | .138          | 15360          | 6550      |                |                    |                |                         |                           |
| CM-243   | 2.437          | 2.355       | .056           | .041  | 2.331          | .049  | .148          | 15760          | 7060      |                |                    |                |                         |                           |
| CM-250   | 2.500          | 2.418       | +.006<br>-.006 | .056  | +.005<br>-.000 | .041  | 2.394         | +.000<br>-.030 | .049      | +.005<br>-.005 | .148               | +.005<br>-.005 | 16160                   | 7250                      |
| CM-255   | 2.559          | 2.473       |                | .056  |                | .043  | 2.449         |                | .049      |                | .148               |                | 16550                   | 7780                      |
| CM-256   | 2.562          | 2.476       |                | .056  |                | .043  | 2.452         |                | .049      |                | .148               |                | 16560                   | 7790                      |
| CM-262   | 2.625          | 2.539       |                | .056  |                | .043  | 2.514         |                | .049      |                | .148               |                | 16970                   | 7980                      |
| CM-268   | 2.688          | 2.597       |                | .056  |                | .045  | 2.572         |                | .049      |                | .158               |                | 17380                   | 8550                      |
| CM-275   | 2.750          | 2.660       |                | .056  |                | .045  | 2.635         |                | .049      |                | .158               |                | 17780                   | 8750                      |
| CM-281   | 2.813          | 2.722       |                | .056  |                | .045  | 2.696         |                | .049      |                | .168               |                | 18190                   | 8950                      |
| CM-287   | 2.875          | 2.781       |                | .056  |                | .047  | 2.755         |                | .049      |                | .168               |                | 18590                   | 9550                      |
| CM-293   | 2.937          | 2.843       |                | .056  |                | .047  | 2.817         |                | .049      |                | .168               |                | 18990                   | 9760                      |
| CM-295   | 2.952          | 2.858       |                | .056  |                | .047  | 2.831         |                | .049      |                | .168               |                | 19090                   | 9810                      |
| CM-300   | 3.000          | 2.904       | .068           | .048  | 2.877          | .061  | .168          | 24150          | 10180     |                |                    |                |                         |                           |
| CM-306   | 3.062          | 2.966       | .068           | .048  | 2.938          | .061  | .168          | 24650          | 10390     |                |                    |                |                         |                           |
| CM-312   | 3.125          | 3.027       | .068           | .049  | 3.000          | .061  | .178          | 25150          | 10820     |                |                    |                |                         |                           |
| CM-314   | 3.149          | 3.051       | .068           | .049  | 3.023          | .061  | .178          | 25350          | 10910     |                |                    |                |                         |                           |
| CM-318   | 3.187          | 3.089       | .068           | .049  | 3.061          | .061  | .178          | 25650          | 11040     |                |                    |                |                         |                           |
| CM-325   | 3.250          | 3.150       | .068           | .050  | 3.121          | .061  | .178          | 26160          | 11490     |                |                    |                |                         |                           |

# CM Spiral Shaft Rings

## External, Medium Duty

These rings offer the greatest economy in price and size. They are able to handle approximately twice the thrust capacity of the CL series, and to be produced to military specifications if needed.

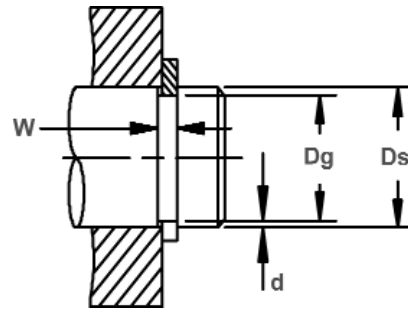
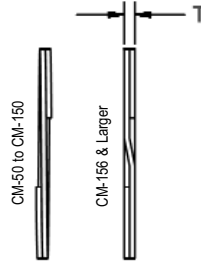
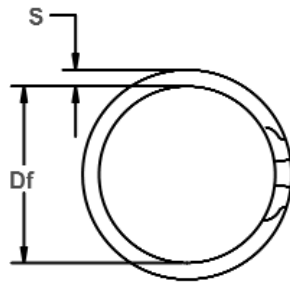

Free Diameter & Ring Measurements

Shaft Diameter & Groove Dimensions

| RING NO. | SHAFT DIAMETER | GROOVE SIZE |        |       |        |       | RING SIZE     |        |           |        |         |        | THRUST LOAD (lbs.)      |                           |
|----------|----------------|-------------|--------|-------|--------|-------|---------------|--------|-----------|--------|---------|--------|-------------------------|---------------------------|
|          |                | DIAMETER    |        | WIDTH |        | DEPTH | FREE DIAMETER |        | THICKNESS |        | SECTION |        | RING Safety factor of 3 | GROOVE Safety factor of 2 |
|          |                | Dg          | Tol.   | W     | Tol.   | d     | Df            | Tol.   | T         | Tol.   | S       | Tol.   |                         |                           |
| CM-331   | 3.312          | 3.208       |        | .068  |        | .052  | 3.180         |        | .061      |        | .188    |        | 26660                   | 12170                     |
| CM-334   | 3.343          | 3.239       |        | .068  |        | .052  | 3.210         | + .000 | .061      |        | .188    |        | 26910                   | 12290                     |
| CM-337   | 3.375          | 3.271       |        | .068  |        | .052  | 3.242         | - .030 | .061      |        | .188    |        | 27170                   | 12410                     |
| CM-343   | 3.437          | 3.331       |        | .068  |        | .053  | 3.301         |        | .061      |        | .188    |        | 27660                   | 12880                     |
| CM-350   | 3.500          | 3.394       |        | .068  |        | .053  | 3.363         |        | .061      |        | .188    |        | 28170                   | 13110                     |
| CM-354   | 3.543          | 3.433       |        | .068  |        | .055  | 3.402         |        | .061      |        | .198    |        | 28520                   | 13770                     |
| CM-356   | 3.562          | 3.452       |        | .068  |        | .055  | 3.422         |        | .061      |        | .198    |        | 28670                   | 13850                     |
| CM-362   | 3.625          | 3.515       |        | .068  |        | .055  | 3.483         |        | .061      |        | .198    |        | 29180                   | 14090                     |
| CM-368   | 3.687          | 3.575       |        | .068  |        | .056  | 3.543         |        | .061      |        | .198    |        | 29680                   | 14600                     |
| CM-374   | 3.740          | 3.628       |        | .068  |        | .056  | 3.597         |        | .061      |        | .198    |        | 30100                   | 14800                     |
| CM-375   | 3.750          | 3.638       |        | .068  |        | .056  | 3.606         |        | .061      |        | .198    |        | 30180                   | 14840                     |
| CM-381   | 3.812          | 3.700       |        | .068  |        | .056  | 3.668         |        | .061      | + .003 | .198    |        | 30680                   | 15090                     |
| CM-387   | 3.875          | 3.757       |        | .068  |        | .059  | 3.724         |        | .061      | - .003 | .208    |        | 31190                   | 16160                     |
| CM-393   | 3.938          | 3.820       |        | .068  |        | .059  | 3.784         |        | .061      |        | .208    | + .005 | 31700                   | 16420                     |
| CM-400   | 4.000          | 3.876       | + .006 | .068  | + .005 | .062  | 3.842         |        | .061      |        | .218    | - .005 | 32200                   | 17530                     |
| CM-406   | 4.063          | 3.939       | - .006 | .068  | - .000 | .062  | 3.906         |        | .061      |        | .218    |        | 32700                   | 17810                     |
| CM-412   | 4.125          | 4.000       |        | .068  |        | .062  | 3.967         |        | .061      |        | .218    |        | 33200                   | 18080                     |
| CM-413   | 4.134          | 4.010       |        | .068  |        | .062  | 3.975         |        | .061      |        | .218    |        | 33270                   | 18120                     |
| CM-418   | 4.188          | 4.058       |        | .068  |        | .065  | 4.022         | + .000 | .061      |        | .218    |        | 33710                   | 19240                     |
| CM-425   | 4.250          | 4.120       |        | .068  |        | .065  | 4.084         | - .040 | .061      |        | .228    |        | 34210                   | 19530                     |
| CM-431   | 4.312          | 4.182       |        | .068  |        | .065  | 4.147         |        | .061      |        | .228    |        | 34710                   | 19810                     |
| CM-433   | 4.331          | 4.200       |        | .068  |        | .065  | 4.164         |        | .061      |        | .228    |        | 34860                   | 19900                     |
| CM-437   | 4.375          | 4.245       |        | .068  |        | .065  | 4.208         |        | .061      |        | .228    |        | 35210                   | 20100                     |
| CM-443   | 4.437          | 4.307       |        | .068  |        | .065  | 4.271         |        | .061      |        | .228    |        | 35710                   | 20390                     |
| CM-450   | 4.500          | 4.364       |        | .068  |        | .068  | 4.326         |        | .061      |        | .238    |        | 36220                   | 21630                     |
| CM-456   | 4.562          | 4.422       |        | .079  |        | .070  | 4.384         |        | .072      |        | .250    |        | 43340                   | 22570                     |
| CM-462   | 4.625          | 4.485       |        | .079  |        | .070  | 4.447         |        | .072      |        | .250    |        | 43940                   | 22890                     |
| CM-468   | 4.687          | 4.547       |        | .079  |        | .070  | 4.508         |        | .072      |        | .250    |        | 44530                   | 23190                     |
| CM-472   | 4.724          | 4.584       |        | .079  |        | .070  | 4.546         |        | .072      |        | .250    |        | 44880                   | 23370                     |
| CM-475   | 4.750          | 4.610       |        | .079  |        | .070  | 4.571         |        | .072      | + .004 | .250    |        | 45130                   | 23500                     |
| CM-481   | 4.812          | 4.672       |        | .079  |        | .070  | 4.633         |        | .072      | - .004 | .250    |        | 45720                   | 23810                     |
| CM-487   | 4.875          | 4.735       |        | .079  |        | .070  | 4.695         |        | .072      |        | .250    |        | 46310                   | 24120                     |
| CM-493   | 4.937          | 4.797       |        | .079  |        | .070  | 4.757         |        | .072      |        | .250    |        | 46900                   | 24430                     |
| CM-500   | 5.000          | 4.856       |        | .079  |        | .072  | 4.816         |        | .072      |        | .250    |        | 47500                   | 25450                     |
| CM-511   | 5.118          | 4.974       |        | .079  |        | .072  | 4.934         |        | .072      |        | .250    |        | 48620                   | 26050                     |
| CM-512   | 5.125          | 4.981       |        | .079  |        | .072  | 4.939         |        | .072      |        | .250    |        | 48690                   | 26080                     |

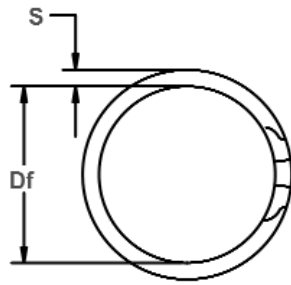

Free Diameter & Ring Measurements

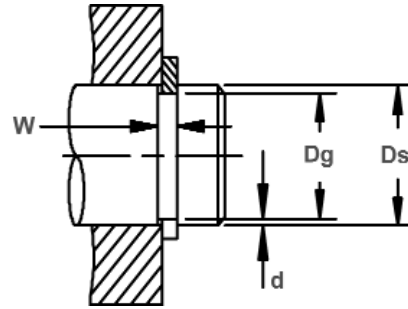
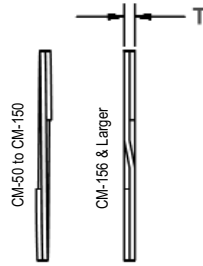

Shaft Diameter & Groove Dimensions

| RING NO. | SHAFT DIAMETER | GROOVE SIZE |        |       |        |       | RING SIZE     |        |      |           |      |         | THRUST LOAD (lbs.) |                         |                           |
|----------|----------------|-------------|--------|-------|--------|-------|---------------|--------|------|-----------|------|---------|--------------------|-------------------------|---------------------------|
|          |                | DIAMETER    |        | WIDTH |        | DEPTH | FREE DIAMETER |        |      | THICKNESS |      | SECTION |                    | RING Safety factor of 3 | GROOVE Safety factor of 2 |
|          |                | (In.)       | Dg     | Tol.  | W      | Tol.  | d             | Df     | Tol. | T         | Tol. | S       | Tol.               |                         |                           |
| CM-525   | 5.250          | 5.107       |        | .079  |        | .072  | 5.064         |        | .072 |           | .250 |         | 49880              | 26720                   |                           |
| CM-537   | 5.375          | 5.228       |        | .079  |        | .074  | 5.187         |        | .072 |           | .250 |         | 51060              | 28120                   |                           |
| CM-550   | 5.500          | 5.353       |        | .079  |        | .074  | 5.308         |        | .072 |           | .250 |         | 52250              | 28770                   |                           |
| CM-551   | 5.511          | 5.364       | + .007 | .079  | + .005 | .074  | 5.320         |        | .072 |           | .250 |         | 52360              | 28830                   |                           |
| CM-562   | 5.625          | 5.478       | - .007 | .079  | - .005 | .074  | 5.433         | + .000 | .072 |           | .250 | - .005  | 53440              | 29420                   |                           |
| CM-575   | 5.750          | 5.597       |        | .079  |        | .077  | 5.550         | - .050 | .072 |           | .250 |         | 54630              | 31300                   |                           |
| CM-587   | 5.875          | 5.722       |        | .079  |        | .077  | 5.674         |        | .072 |           | .250 |         | 55810              | 31980                   |                           |
| CM-590   | 5.905          | 5.752       |        | .079  |        | .077  | 5.705         |        | .072 |           | .250 |         | 56100              | 32140                   |                           |
| CM-600   | 6.000          | 5.847       |        | .079  |        | .077  | 5.798         |        | .072 |           | .250 |         | 57000              | 32660                   |                           |
| CM-612   | 6.125          | 5.953       |        | .094  |        | .086  | 5.903         |        | .086 |           | .312 |         | 69500              | 37230                   |                           |
| CM-625   | 6.250          | 6.078       |        | .094  |        | .086  | 6.026         |        | .086 |           | .312 |         | 70920              | 37990                   |                           |
| CM-629   | 6.299          | 6.127       |        | .094  |        | .086  | 6.076         |        | .086 |           | .312 |         | 71480              | 38290                   |                           |
| CM-637   | 6.375          | 6.203       |        | .094  |        | .086  | 6.152         |        | .086 |           | .312 |         | 72340              | 38750                   |                           |
| CM-650   | 6.500          | 6.328       |        | .094  |        | .086  | 6.274         |        | .086 |           | .312 |         | 73760              | 39510                   |                           |
| CM-662   | 6.625          | 6.443       |        | .094  |        | .091  | 6.390         | + .000 | .086 |           | .312 |         | 75180              | 42620                   |                           |
| CM-675   | 6.750          | 6.568       |        | .094  |        | .091  | 6.513         | - .060 | .086 |           | .312 |         | 76600              | 43420                   |                           |
| CM-687   | 6.875          | 6.693       |        | .094  |        | .091  | 6.638         |        | .086 |           | .312 |         | 78010              | 44220                   |                           |
| CM-700   | 7.000          | 6.818       |        | .094  |        | .091  | 6.761         |        | .086 |           | .312 |         | 79430              | 45030                   |                           |
| CM-712   | 7.125          | 6.933       |        | .094  |        | .096  | 6.877         |        | .086 | + .004    | .312 |         | 80850              | 48350                   |                           |
| CM-725   | 7.250          | 7.058       |        | .094  |        | .096  | 6.999         |        | .086 | - .004    | .312 |         | 82270              | 49200                   |                           |
| CM-737   | 7.375          | 7.183       |        | .094  |        | .096  | 7.125         |        | .086 |           | .312 |         | 83690              | 50050                   |                           |
| CM-750   | 7.500          | 7.308       | + .008 | .094  | + .006 | .096  | 7.250         |        | .086 |           | .312 | + .006  | 85110              | 50890                   |                           |
| CM-762   | 7.625          | 7.423       | - .008 | .094  | - .006 | .101  | 7.363         |        | .086 |           | .312 | - .006  | 86520              | 54440                   |                           |
| CM-775   | 7.750          | 7.548       |        | .094  |        | .101  | 7.486         |        | .086 |           | .312 |         | 87940              | 55330                   |                           |
| CM-787   | 7.875          | 7.673       |        | .094  |        | .101  | 7.611         |        | .086 |           | .312 |         | 89360              | 56220                   |                           |
| CM-800   | 8.000          | 7.798       |        | .094  |        | .101  | 7.734         |        | .086 |           | .312 |         | 90780              | 57110                   |                           |
| CM-825   | 8.250          | 8.038       |        | .094  |        | .106  | 7.972         |        | .086 |           | .375 |         | 93620              | 61820                   |                           |
| CM-850   | 8.500          | 8.288       |        | .094  |        | .106  | 8.220         | + .000 | .086 |           | .375 |         | 96450              | 63690                   |                           |
| CM-875   | 8.750          | 8.528       |        | .094  |        | .111  | 8.459         | - .070 | .086 |           | .375 |         | 99290              | 68650                   |                           |
| CM-900   | 9.000          | 8.778       |        | .094  |        | .111  | 8.707         |        | .086 |           | .375 |         | 102130             | 70620                   |                           |
| CM-925   | 9.250          | 9.018       |        | .094  |        | .116  | 8.945         |        | .086 |           | .375 |         | 104960             | 75850                   |                           |
| CM-950   | 9.500          | 9.268       |        | .094  |        | .116  | 9.194         |        | .086 |           | .375 |         | 107800             | 77900                   |                           |
| CM-975   | 9.750          | 9.508       |        | .094  |        | .121  | 9.432         |        | .086 |           | .375 |         | 110640             | 83390                   |                           |
| CM-1000  | 10.000         | 9.758       |        | .094  |        | .121  | 9.680         |        | .086 |           | .375 |         | 113470             | 85530                   |                           |
| CM-1025  | 10.250         | 9.998       |        | .094  |        | .126  | 9.918         |        | .086 |           | .375 |         | 116310             | 91290                   |                           |
| CM-1050  | 10.500         | 10.248      |        | .094  |        | .126  | 10.166        |        | .086 |           | .375 |         | 119150             | 93520                   |                           |
| CM-1075  | 10.750         | 10.488      |        | .094  |        | .131  | 10.405        |        | .086 |           | .375 |         | 121990             | 99540                   |                           |
| CM-1100  | 11.000         | 10.738      |        | .094  |        | .131  | 10.653        |        | .086 |           | .375 |         | 124820             | 101860                  |                           |